

✗ How to assemble this map

The following pages are provided for teachers to print and assemble their own maps.

Print this document on single-sided paper.
Then, tape the pages together.

Your final map should look like the image below.

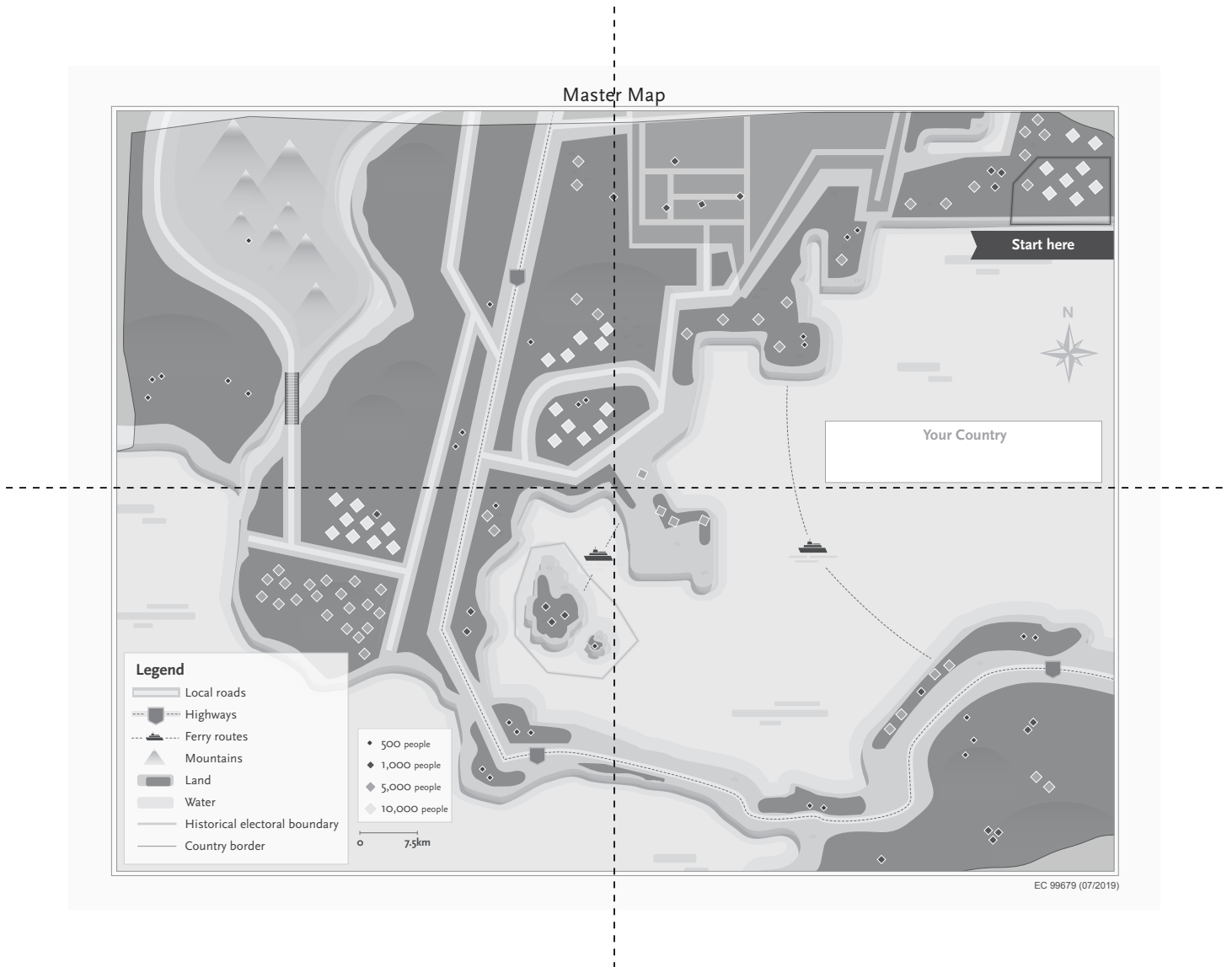

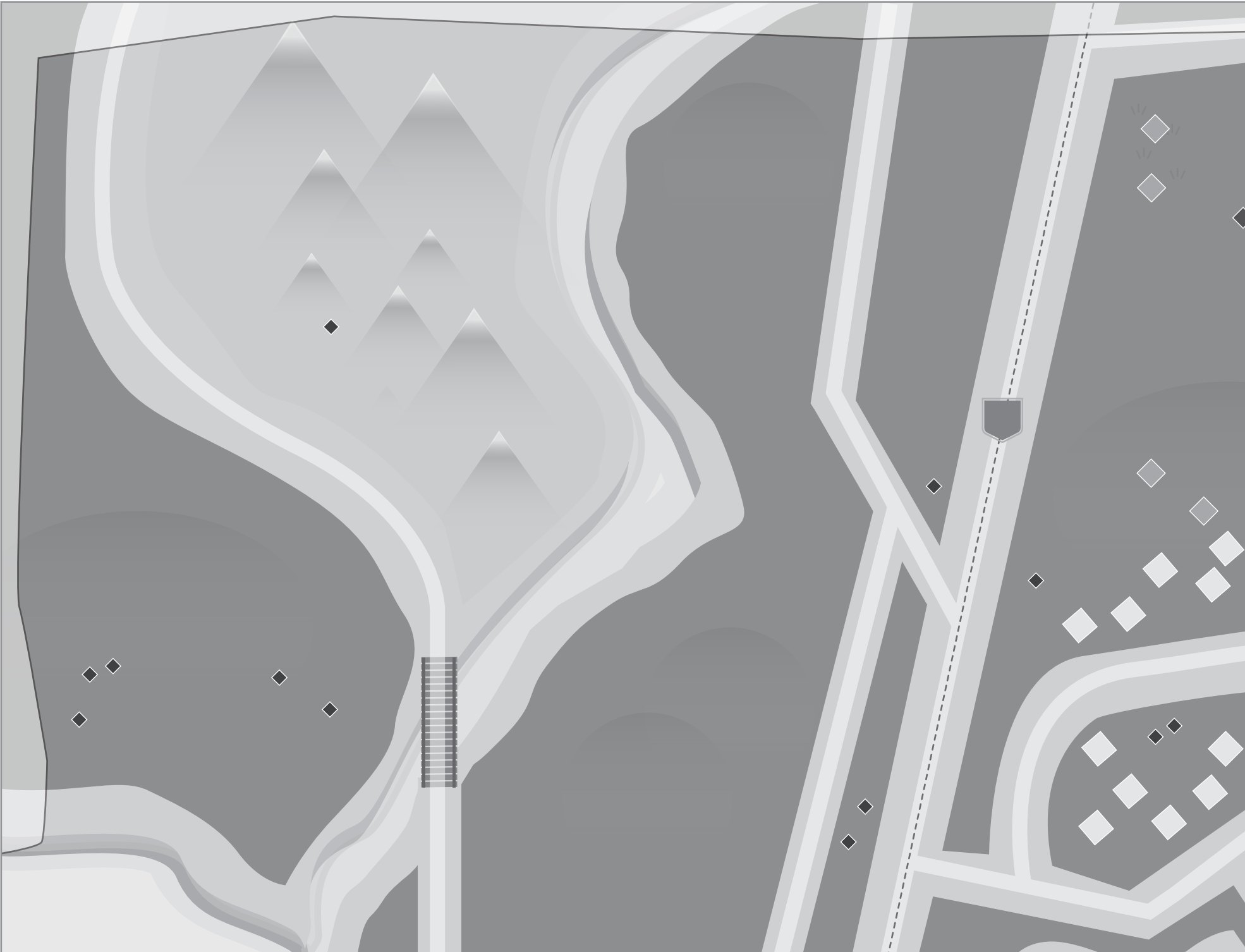

r Map

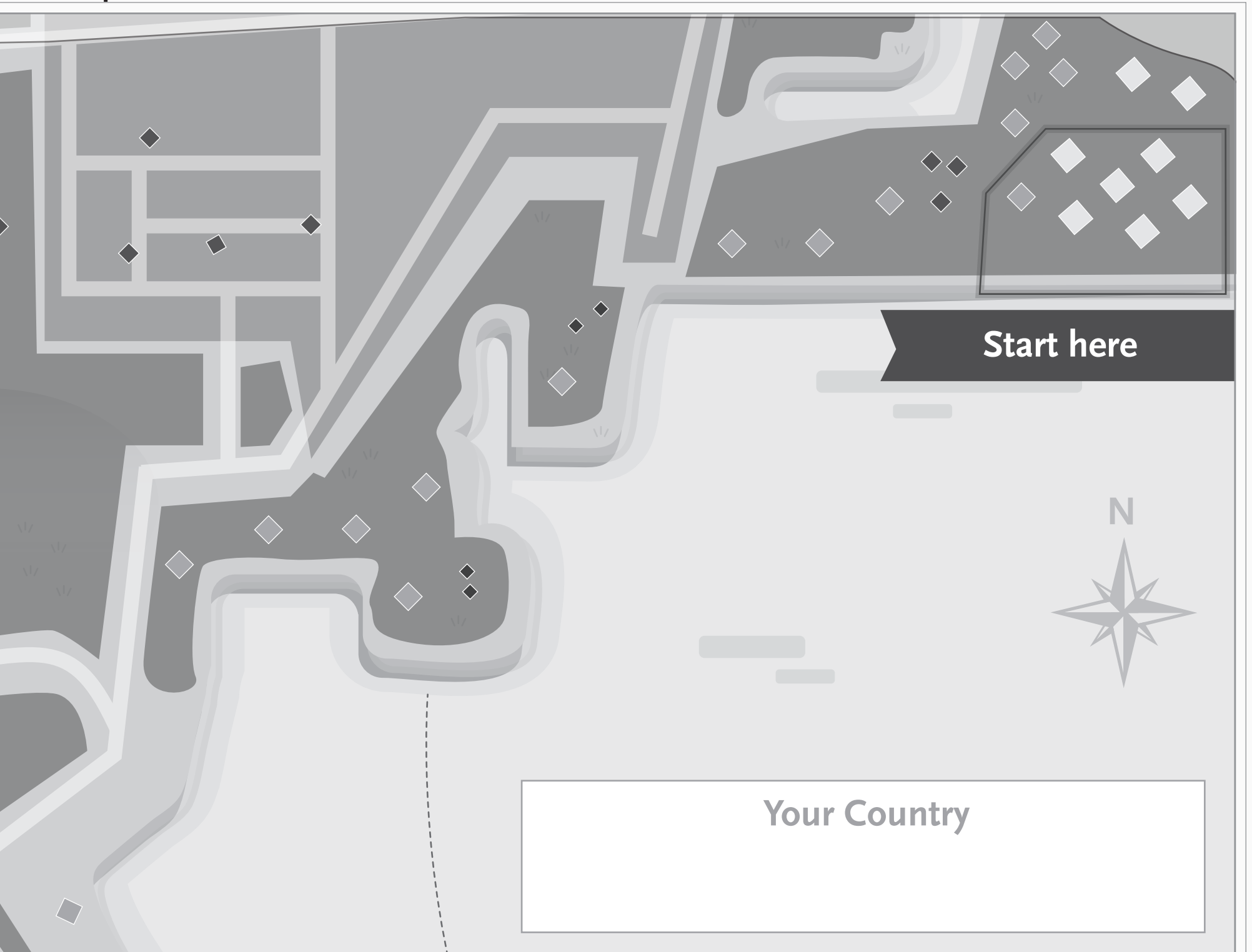

Legend

 Local roads

 Highways

 Ferry routes

 Mountains

 Land

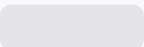
 Water

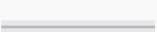
 Historical electoral boundary

 Country border

 500 people

 1,000 people

 5,000 people

 10,000 people

 7.5km

